

# microlab



microlab

Art For The Ear



FC362  
User Manual

Microlab Technology Co.,Ltd  
Made in China

No.:80-FC361(10)-97-0001-01

All symbols and logo belong to the respective brand holder or registered holder. All specifications and information are subject to changes without further notice. Slight variations and differences might appear between the printed photos and actual product due to product enhancement.

Before using, please read the manual carefully

FineCone Speakers



## Important Safety Instructions



### Caution:

To reduce the risk of electric shock, do not dismantle the product and do not expose the apparatus to rain or moisture. No user-serviceable parts inside. Refer servicing to qualified personnel only.

### Explanation of Graphical Symbols:

-  The lightning flash within an equilateral triangle is intended to alert you to the presence of uninsulated "dangerous voltage" within the product's enclosure that may be of sufficient magnitude to constitute an electric shock to a person or persons.
-  The exclamation point within an equilateral triangle is intended to alert you to the presence of important operating and maintenance (servicing) instructions in the literature accompanying the product.

### WARNINGS:

1. Read Instructions - All the safety and operating instructions must be read before the product is operated.
2. Retain Instructions - The safety and operating instructions should be kept product for future reference.
3. Heed warnings - All warnings on the product and in the operating instructions should be adhered to.
4. Follow instructions - All operating and use instructions should be followed.
5. Installation - Install in accordance with the manufacturer's instructions.
6. Power sources - This product should be operated only from the type of power source indicated by the marking adjacent to the power cord entry. If you are not sure of the type of power supply to your home, consult your product dealer or local power company.
7. Grounding or polarization - the product is not required to be grounded. Ensure the plug is fully inserted into the wall outlet or extension cord receptacle to prevent blade or pin exposure. Some versions of the product are equipped with a power cord fitted with a polarized alternating line plug (a plug having one blade wide than the other). This plug will fit onto the power outlet only one way. This is a safety feature. If you are unable to insert the plug fully into the outlet, try reversing the plug. If the plug should still fail to fit, contact your electrician to replace your obsolete outlet. Do not defeat the safety purpose of the polarized plug. When using an extension power-supply cord or a power-supply cord other than that supplied with the appliance, it should be fitted with the appropriate molded plugs and carry safety approval appropriate to the country of use.
8. Power cord protection - Power-supply cords should be routed so that they are not likely to be walked on, kinked or pinched by items placed on or against them, paying particular attention to cords from plugs, receptacles and the point where they exit from the appliance.
9. Overloading - Do not overload wall outlets, extension cords or multiple sockets, as this can result in a risk of fire or electric shock.
10. Ventilation - The product must be properly ventilated. Do not place the product on a bed, sofa, or other similar surface. Do not cover the product with any items such as tablecloths, newspapers, etc.
11. Heat - The product should be situated away from heat sources such as radiators, heat registers, stoves, or other products) including amplifiers that produce heat. No naked flame sources, such as lighted candles, should be placed on the apparatus.
12. Water and moisture - To reduce the risk of fire or electric shock, do not expose the product to rain, dripping, splashing or excessive moisture such as in a sauna or bathroom. Do not use this product near water for example, near a bathtub, washbowl, kitchen sink, laundry tub, in a wet basement, or near a swimming pool and the like.
13. Object and Liquid Entry - Never push objects of any kind into this product through openings, as they may touch dangerous voltage points or short-circuit parts that could result in a fire or electric shock. Never spill liquid of any kind on the product. Do not place any object containing liquid on top of the product.
14. Cleaning - Unplug the product from the wall outlet before cleaning. The cabinet of the subwoofer may be cleaned by dusting with a dry cloth. If you wish to use an aerosol cleaning spray, do not spray directly on the cabinet; spray onto the cloth. Be careful not to damage the drive units.
15. Attachments - Do not use attachments not recommended by the product manufactures, as they may cause hazards.
16. Accessories - Do not place this product on an unstable cart, stand, tripod, bracket or table. The product may fall, causing serious injury to a child or adult, and serious damage to the product. Use only with a cart, stand, tripod, bracket or table recommended by the manufacturer or sold with the product. Any mounting of the product should follow the manufacturer's instructions and should use a mounting accessory recommended by the manufacturer.
17. Moving the product - A product and cart combination should be moved with care. Quick stops, excessive force and uneven surfaces may cause the product and cart combination to overturn.
18. Unused periods - The power cord of the appliance should be unplugged from the outlet during lightning storms or when the apparatus is left unused for a long period of time.

19. Servicing - Do not attempt to service this product yourself, as opening or removing covers may expose you to dangerous voltage or other hazards. Refer all servicing to qualified service personnel.
20. Please remove the power plug from the main power source or wall power source when not in use. When plugged in to a power source, the system is in standby mode, so the power is not entirely cut off.
21. Replacement parts - When replacement parts are required, ensure the service technician has used replacement parts specified by the manufacturer or have the same characteristics as the original part. Unauthorized substitutions may result in fire, electric shock or other hazards.
22. Mains fuses - For continued protection against fire hazard, use fuses only of the correct type and rating. The correct fuse specification for each voltage range is marked on the product.
23. Do not turn up the volume while listening to a section with very low level inputs or no audio signals. If you do, the speaker may be damaged when a peak level section is suddenly played.
24. The only means of completely disconnecting the product from the power supply is by removing the power cord from the wall outlet or the product. The wall outlet or the power cord entry to the product must remain freely accessible at all times while the product is in use.
25. Try to install the product near a wall socket or extension cord and shall be easily accessible.
26. The highest environmental temperature suitable for this product is 40°C.

## Introduction

High Fidelity 2.1 speaker system with the excellent FineCone drivers

Microlab premier range, the FC series is based on the FINE CONE designed by acoustic expert, Peter Larsen that attains perfect linear frequency response curve. This characteristics offers distortion free and uncoloured sound. Perfect sound everytime from your music playbacks and for your perfect entertainment.

Uncolored audio, precise position, and high resolution with Microlab own eAirbass technology.

### Features

High Fidelity 2.1 subwoofer speaker system with crystal clear acoustics and rich sound 6.5" woofer and 2.5" x 2 V16 full range speakers with perfect linear frequency response curve, designed by Danish acoustic master, Peter Larsen.

Superb dynamics, depth and deep bass - ideal for all audio type of playbacks

Slim satellites with tight and clear acoustics

Standalone amplifier unit for distortion free and interference free audio, with front controls for easy access.

### Package contents

FC362 subwoofer	1pcs
FC362 satellites	2pc
3.5mm stereo - 2RCA cable	1pc
User manual	1pc

**Illustrations**

**Front panel**

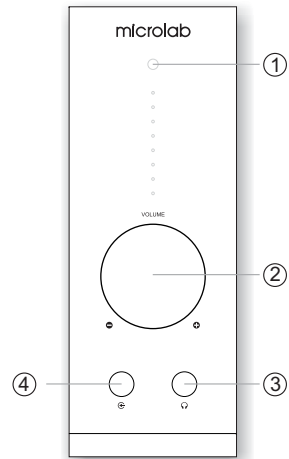

1. Power LED: illuminates in green when power is turn on
2. Master volume knob: adjust volume level
3. Earphone output jack: allows 3.5mm stereo plug connection for earphones
4. Audio source input jack: allows 3.5mm stereo plug for connection to media player source such as computer sound card, CD / DVD, Mp3 / Mp4 player, etc.

**Top panel**

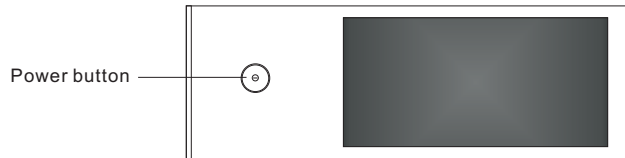

**Rear panel**

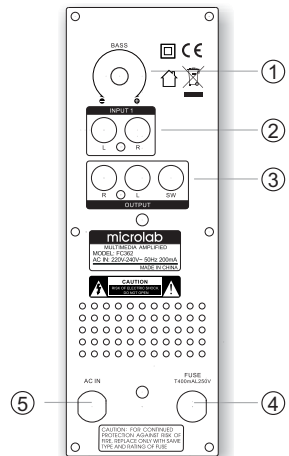

1. Bass volume knob: allows bass volume adjustment on the subwoofer.
2. Input 1: 2 x RCA jacks for input source connection from any media sources such as CD / DVD, Mp3 / Mp4 player or TV.
3. Output connections: connect to left and right satellites, and subwoofer.
4. Fuse: fuse socket
5. Power line: AC power source input

**Connections and Operations**

**Connections**

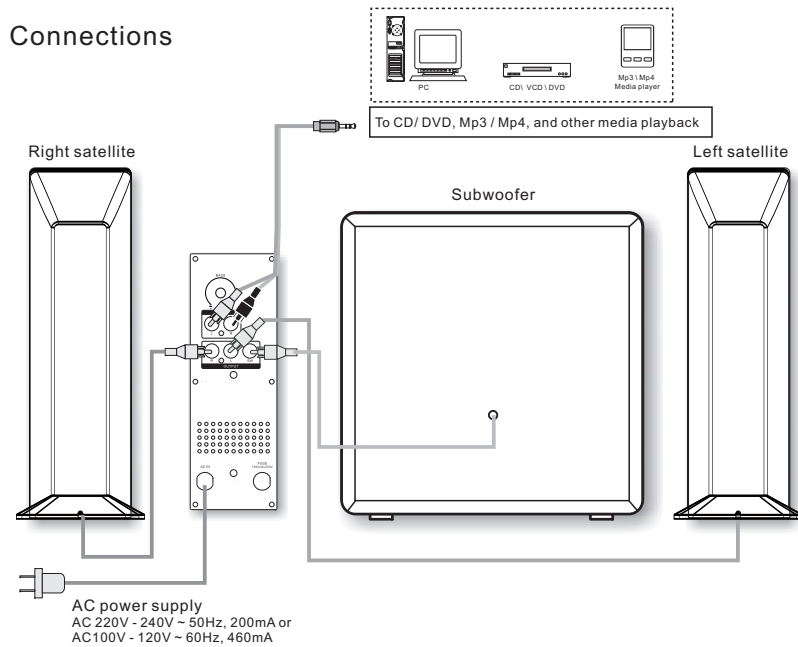

**Connections**

1. Connect the satellites to the left and right RCA interfaces. Connect the subwoofer to the SW input jack.
2. Place both satellites on extreme sides of the listening position and the subwoofer on the floor with its back close to a wall.
3. Connect the playback device to the rear input RCA interface of the amplifier with the included cable, or to the front 3.5mm stereo input jack.
4. The amplifier should be placed near a power source and near the playback device such as CD/DVD, Mp3/Mp4 player or TV.
5. Last, connect the AC power cable at the rear of the amplifier to the AC power supply source. Please ensure the AC power supply match the power requirement printed at the rear panel.

**Operations**

1. Ensure the master volume is at the lowest setting.
2. Turn on the main AC power and switch on the amplifier from the top power button.
3. Start the playback device and song.
4. Slowly adjust the volume to your preferred volume level and enjoy.

Note: it is advisable not to turn the volume too loud or to its extreme volume limit to avoid damage to the speaker driver material. Always adjust in slow increment.  
Do not block the ventilation of the amplifier during use.

**Specifications**

**AMPLIFIER**

Output power: 54 Watt RMS  
 Power distribution: 15 Watt x 2 + 24 Watt  
 Harmonic distortion: < 0.3% 1W 1kHz  
 Frequency response: 35Hz - 20kHz  
 Signal/Noise ratio: > 75dB  
 Separation: > 45dB

**SPEAKERS**

Tweeter driver type: 2.5" x 2  
 Tweeter rated power: 15 Watt x 2, 4 ohm  
 Bass driver type: 6.5" - eAirbass  
 Bass rated power: 30 Watt, 8 ohm  
 Frequency range: 35Hz - 20kHz

**INTERFACES**

Output: RCA sockets x 3  
 Input: 3.5mm Stereo, 2RCA sockets

**POWER**

Power supply: AC 220V - 240V ~ 50Hz, 200mA or  
 AC100V - 120V ~ 60Hz, 460mA

**Frequently Asked Questions (FAQ)**

	Solutions
No Sound	Check if the audio source is working well Check if the audio and speaker cables well connected Check if the volume at right level
One or more satellite no sound	Check if the satellite cable well connected, and ensure source connection is correctly inserted
Static sound heard when volume knob is turned	Turn off the playback source first, then turn the speaker volume knob several times. Playback again and monitor. The static noise is due to dust, so simply turning the volume will remove it easily.
What are the products supported?	Any playback devices such as PC, notebook, CD/DVD player, Media Players with 3.5mm stereo plug.
Sound is distorted	Check if the source file is not corrupted, play a different song and test.
Where to place this speaker	It is magnetically shielded so can be placed near LCD TV Monitor without any distortion
If the problem still exists, please contact the distributor or seek professional advice.	

2.1 subwoofer arrangement  
 Ideal listening position and placement

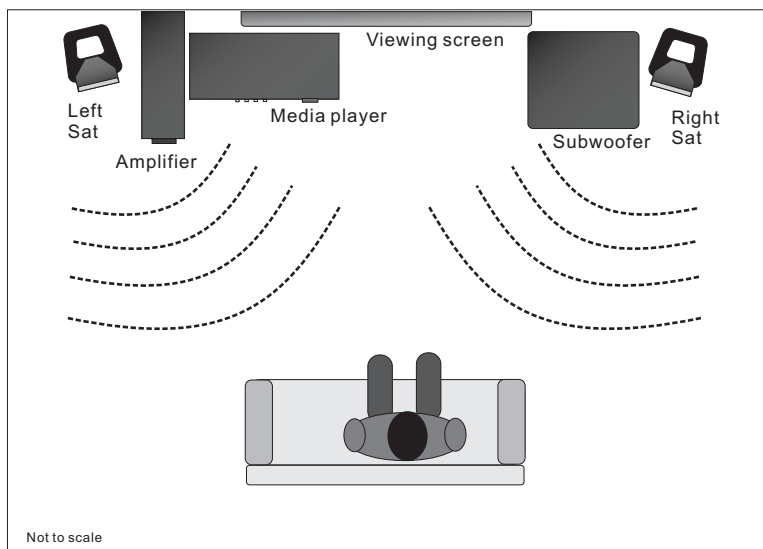

- The end -

All rights reserved  
 © 2010 Microlab Technology Co., Ltd  
 All specifications and information are subject to changes without further notice